

Providing Security Through Handmade Blankets for Children- A 100% volunteer, non-profit 501 (c) (3) charitable organization

Chapter Coordinators – Judi Goldman – 847.498.3987 & Penny Gidd - 847.521.0672

637 Charlemagne, Northbrook, IL 60062

Chapter website: [www.projectlinuschicago.com](http://www.projectlinuschicago.com) e-mail: [linuschicagoland@gmail.com](mailto:linuschicagoland@gmail.com)

## Perfect Pinwheel Quilt Block

As contributed by Jane Stephens, Dearborn/Wayne County MI Chapter

For one 12 ½" unfinished Perfect Pinwheel block you will need:

One 10 ½" square of background fabric

One 10 ½" square of the pinwheel fabric

1. Place 10 ½" fabric squares (background/pinwheel fabrics) right sides together and pin to secure.
2. Stitch ¼" around all edges of the square, as pictured and cut square on both diagonals creating four half-square triangles.

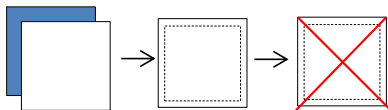

3. Open and press toward the dark fabric.

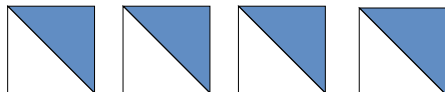

4. Cut each square in half, as pictured. Make sure the pinwheel fabric is on the top left corner of the half-square triangles so that the pinwheels will all be going in the same direction. Then flip the right section vertically as pictured. Sew sections together and trim to a 6 ½" square by cutting extra fabric off as pictured.

- 5.

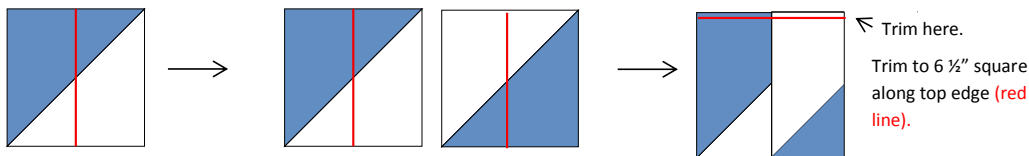

6. Lay out pinwheel blocks as pictured below and sew sections together with a ¼" seam. Add borders if you like or just layer top, batting and backing and quilt as desired.

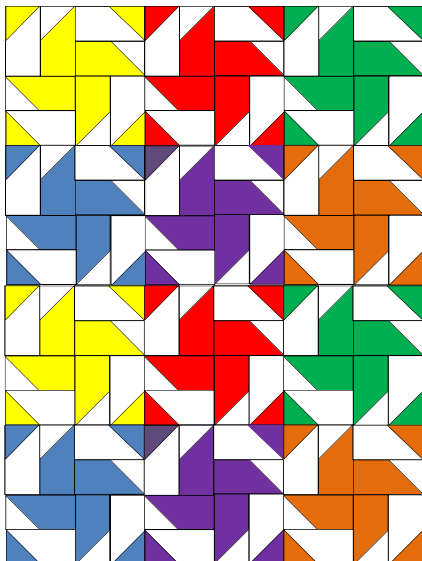

**To make quilt pictured you will need:**

12 – 10 ½" squares of background fabric (Approx. 1 yard)

12 – 10 ½" squares of a variety of prints.

½ yard binding

Backing and Batting: 36" x 48"

